



HURRICANE BELLEVILLE FIBERGLASS DOOR UNIT  
6'-8" DOUBLE DOOR WITH / WITHOUT SIDELITES

GENERAL NOTES

1. EVALUATED FOR USE IN LOCATIONS ADHERING TO THE FLORIDA BUILDING CODE AND WHERE PRESSURE REQUIREMENTS AS DETERMINED BY ASCE 7, MINIMUM DESIGN LOADS FOR BUILDINGS AND OTHER STRUCTURES, DOES NOT EXCEED THE DESIGN PRESSURES LISTED.
2. THIS PRODUCT DOES NOT REQUIRE THE USE OF A HURRICANE PROTECTIVE DEVICE (SHUTTERS).
3. POLYURETHANE CORE FLAME SPREAD INDEX OF 50 AND SMOKE DEVELOPED INDEX OF 60 PER ASTM E84.
4. PLASTICS TESTING OF FIBERGLASS FACING:

TEST DESCRIPTION	DESIGNATION	RESULT
SELF IGNITION TEMP	ASTM D1929	803 °F > 650 °F
RATE OF BURNING	ASTM D635	0.79 IN/MIN (C-1)
SMOKE DENSITY	ASTM D2843	48.9%
TENSILE STRENGTH*	ASTM D638	-7.3% DIFF

\* COMPARATIVE TENSILE STRENGTH AFTER WEATHERING  
4500 HOURS XENON ARC METHOD 1

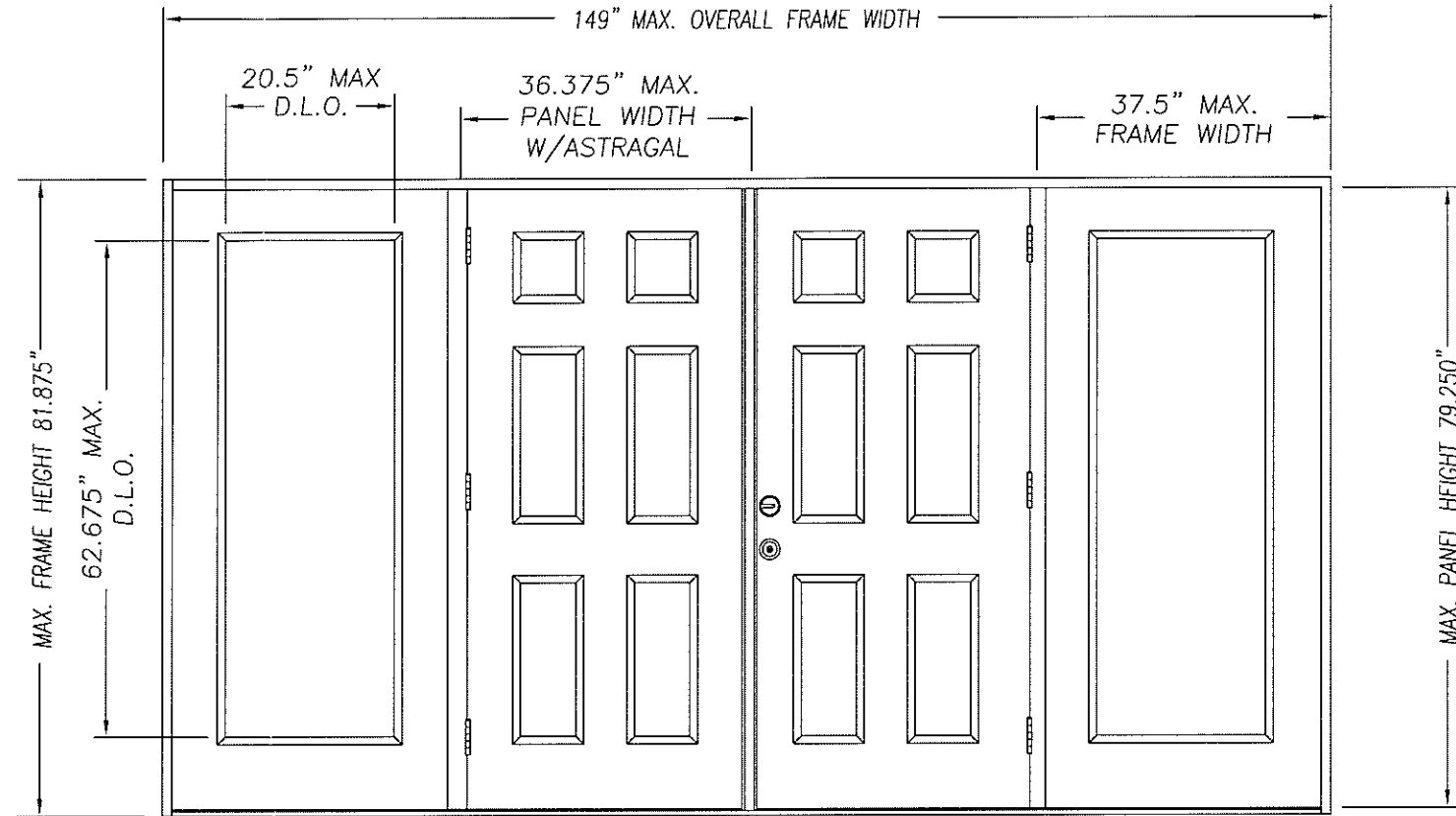

DOUBLE DOOR UNIT W/SIDELITES

Addendum to NAM

Certification No.: 21005930-R7  
Reviewed By: [Signature]  
Date Reviewed: 12/17/08

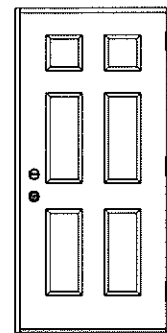

SINGLE DOOR UNIT

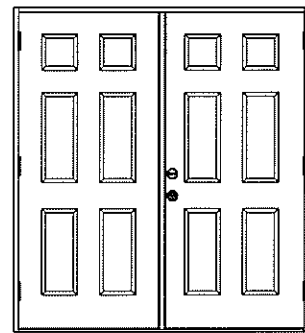

DOUBLE DOOR UNIT

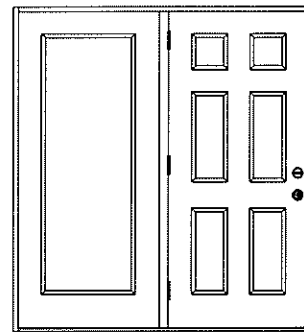

SINGLE DOOR UNIT  
WITH SIDELITE

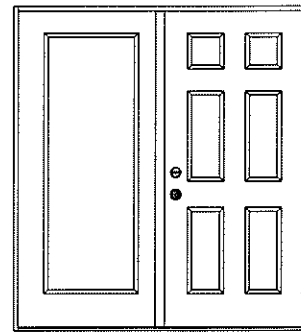

SINGLE DOOR UNIT  
WITH SIDELITE

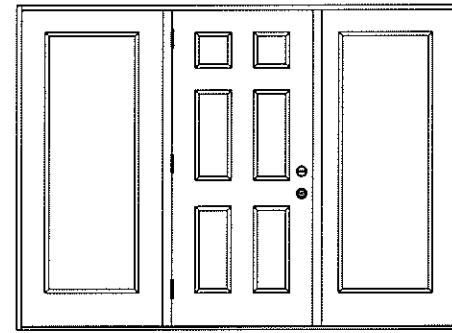

SINGLE DOOR UNIT W/SIDELITES

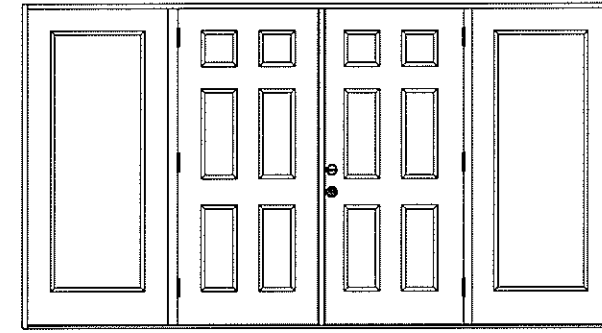

DOUBLE DOOR UNIT W/SIDELITES

TABLE OF CONTENTS	
SHEET #	DESCRIPTION
1	TYPICAL ELEVATIONS & GENERAL NOTES
2	ANCHOR LOCATIONS & DETAILS
3	ANCHORING LOCATIONS & DETAILS

CONFIG	MAX WIDTH	DESIGN PRESSURE RATING		WHERE WATER INFILTRATION PERFORMANCE IS REQUIRED TO BE 15% OF DESIGN PRESSURE		
		INSWING	OUTSWING	INSWING	OUTSWING	OUTSWING*
X	37.5"	+70.0 / -70.0	+70.0 / -70.0	+19.0 / -19.0	+70.0 / -70.0	+70.0 / -70.0
XX	74"	+50.5 / -50.5	+55.0 / -50.5	+19.0 / -19.0	+40.0 / -40.0	+55.0 / -50.5
OX or XO	75"	+50.5 / -50.5	+55.0 / -50.5	+19.0 / -19.0	+40.0 / -40.0	+55.0 / -50.5
OXO	112.5"	+50.5 / -50.5	+55.0 / -50.5	+19.0 / -19.0	+40.0 / -40.0	+55.0 / -50.5
OXXO	149"	+50.5 / -50.5	+55.0 / -50.5	+19.0 / -19.0	+40.0 / -40.0	+55.0 / -50.5

\* High Dam Threshold Design

MASONITE INTERNATIONAL CORP.  
7300 REAMES RD.  
CHARLOTTE, NC 28216

PRODUCT:  
"EXTERIOR DOOR PRODUCT"  
DOUBLE 6'8" OPAQUE  
FIBERGLASS DOOR  
PART OR ASSEMBLY:  
TYPICAL ELEVATIONS  
& GENERAL NOTES

NO.	DATE	ADDED	SWS	SWS	SWS	SWS	SWS	SWS	BY	REVISIONS			
											ADDED	SPACER	HINGE
F	12/15/08												
E	1/2/08												
D	4/9/07												
C	4/25/05												
B	3/1/05												
A	2/22/05												

DATE: 2/11/05  
SCALE: N.T.S.  
DWG. BY: SWS  
CHK. BY:  
DRAWING NO.:  
DWG-MA-FL0120-05  
SHEET 1 OF 3



MASONITE INTERNATIONAL CORP.  
 7300 REAMES RD.  
 CHARLOTTE, NC 28216

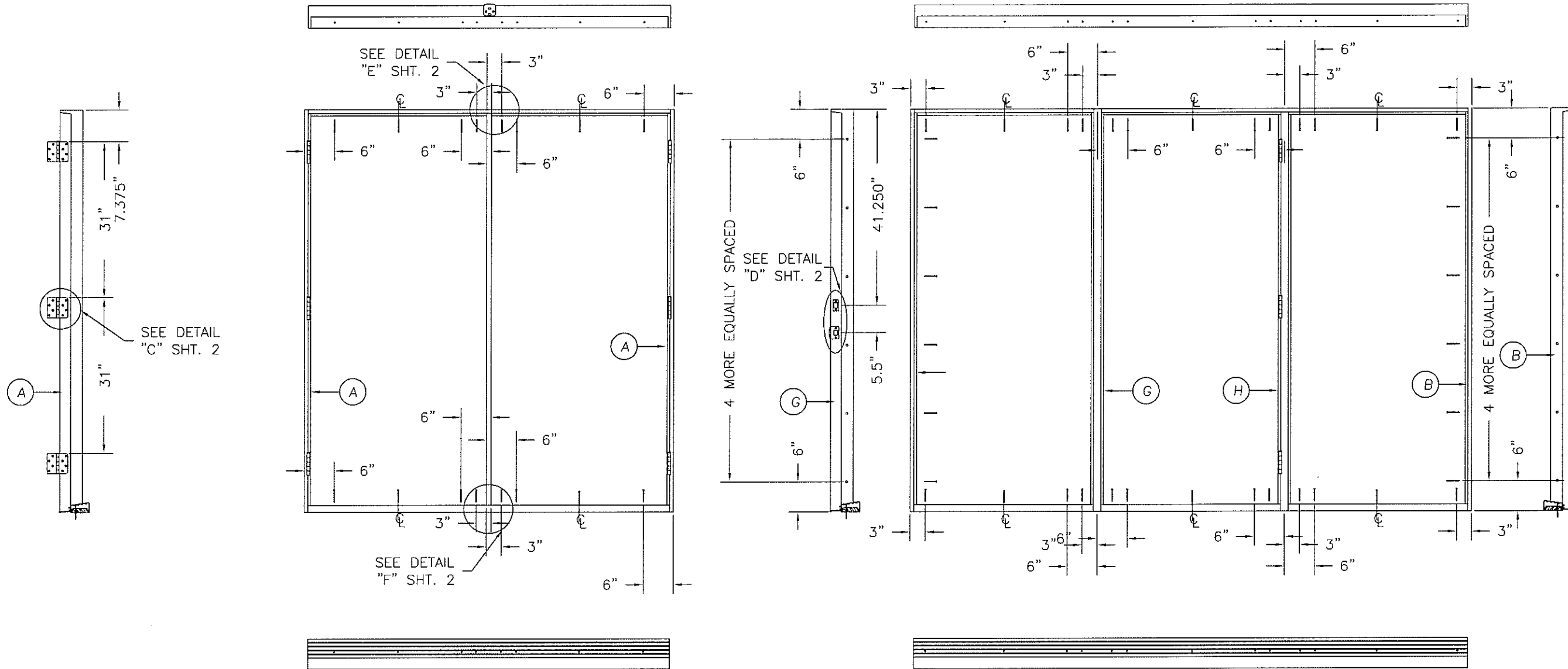

**ATTACHMENT DETAIL**

1. ANCHOR ANALYSIS FOR LOADING CONDITIONS PREPARED, SIGNED AND SEALED BY HAROLD E. RUPP, PE (FLORIDA #15935) WITH THE LOWEST (LEAST) FASTENER RATING FROM THE DIFFERENT FASTENERS BEING CONSIDERED FOR USE. JAMB, HEAD, AND THRESHOLD FASTENERS ANALYZED FOR THIS UNIT INCLUDE #10 WOOD SCREWS OR 3/16" TAPCONS. A PHYSICAL SHIM MUST BE PLACED IN SHIM SPACE AT EACH ANCHOR LOCATION.
2. THE WOOD SCREW SINGLE SHEAR DESIGN VALUES COME FROM ANSI/AF&PA NDA FOR SOUTHERN PINE LUMBER AND ACHIEVEMENT OF 1-1/2" MINIMUM EMBEDMENT. THE TAPCON MUST ACHIEVE MINIMUM EMBEDMENT OF 1-1/4".
3. WOOD BUCKS BY OTHERS MUST BE ANCHORED PROPERLY TO TRANSFER LOADS TO STRUCTURE.
4. MINIMUM DESIGN VALUE STRENGTH OF ANCHORS 171 LBS.

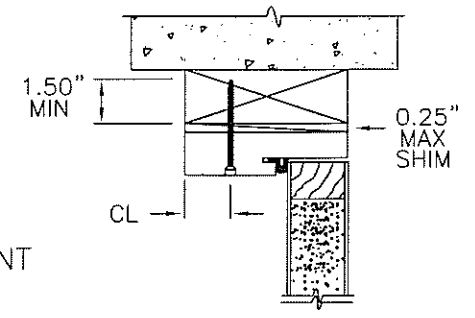

TYPICAL ANCHOR INSTALLATION  
 4-9/16" MIN JAMB

**HARDWARE SCHEDULE**

1. KWIKSET MAXIMUM SECURITY SERIES GRADE 2 CYLINDRICAL AND DEADLOCK HARDWARE TO BE INSTALLED AT 5-1/2" CENTERLINE.
2. 4" X 4" FULL MORTISE BUTT HINGES.

Addendum to NAM  
 Certification No.: N1005930-R7  
 Reviewed By: [Signature]  
 Date Reviewed: 12/17/08

PRODUCT:		"EXTERIOR DOOR PRODUCT" 6'-8" FIBERGLASS OPAQUE DOUBLE DOOR UNIT	
PART OR ASSEMBLY:		ANCHORING LOCATIONS & DETAILS	
12/15/08	ADDED SPACER	SWS	BY
1/2/08	HINGE SCREW LENGTH	SWS	REVISIONS
4/9/07	GENERAL REVISIONS	SWS	
4/25/05	ANCHORS & PLASTICS	SWS	
3/1/05	FLORIDA CHANGES	SWS	
2/22/05	ADDED GLASS DETAIL	SWS	
	DATE		

DATE: 2/11/05  
 SCALE: N.T.S.  
 DWG. BY: SWS  
 CHK. BY:  
 DRAWING NO.:  
 DWG-MA-FL0120-05  
 SHEET 3 OF 3