



**SIDE-HINGED WOOD-EDGE STEEL DOOR UNIT
8'-0" GLAZED DOUBLE DOOR WITH / WITHOUT SIDELITES**

GENERAL NOTES

- EVALUATED FOR USE IN LOCATIONS ADHERING TO THE FLORIDA BUILDING CODE AND WHERE PRESSURE REQUIREMENTS AS DETERMINED BY ASCE 7, MINIMUM DESIGN LOADS FOR BUILDINGS AND OTHER STRUCTURES, DOES NOT EXCEED THE DESIGN PRESSURES LISTED.
- HURRICANE PROTECTIVE SYSTEM (SHUTTERS) IS REQUIRED.
- POLYURETHANE CORE FLAME SPREAD INDEX OF 50 AND SMOKE DEVELOPED INDEX OF 60 PER ASTM E84.
- PLASTICS TESTING OF LITE FRAME MATERIAL:

TEST DESCRIPTION	DESIGNATION	RESULT
SELF IGNITION TEMP	ASTM D1929	680 °F > 650 °F
RATE OF BURNING	ASTM D635	1.10 IN/MIN
SMOKE DENSITY	ASTM D2843	69.6%
TENSILE STRENGTH*	ASTM D638	-7.48% DIFF

* COMPARATIVE TENSILE STRENGTH AFTER WEATHERING 4500 HOURS XENON ARC METHOD 1

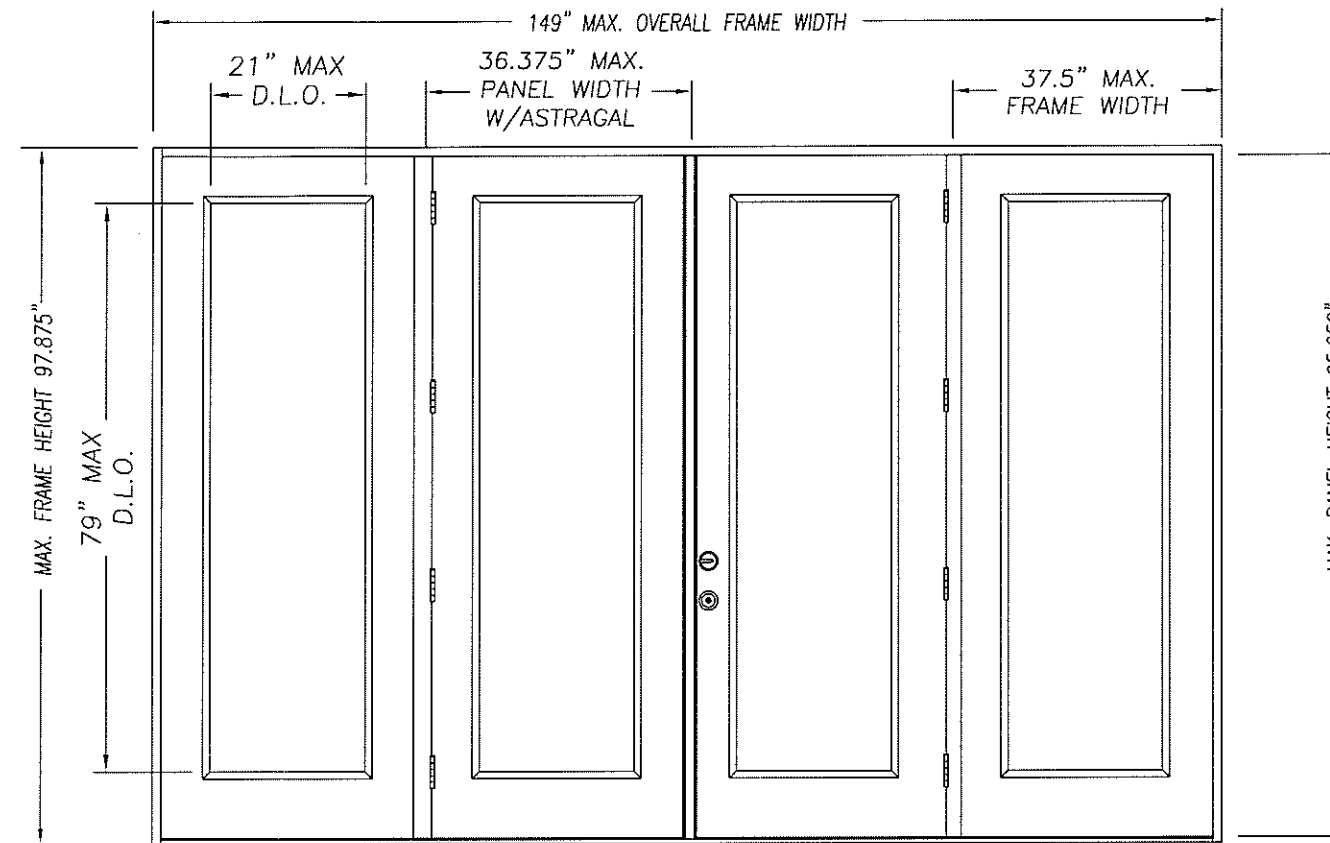

DOUBLE DOOR UNIT W/SIDELITES

Addendum to NAMI

Certification No.: N1006110-R3
 Reviewed By: [Signature]
 Date Reviewed: 12/18/08

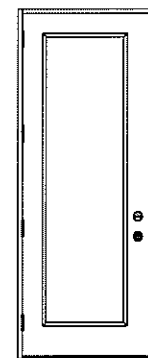

SINGLE DOOR UNIT

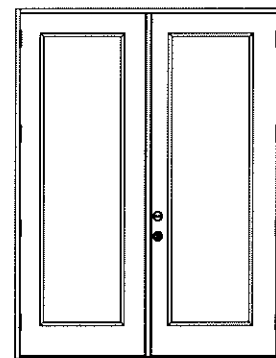

DOUBLE DOOR UNIT

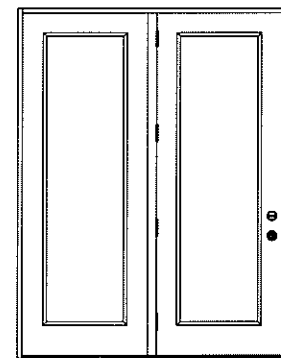

SINGLE DOOR UNIT WITH SIDELITE

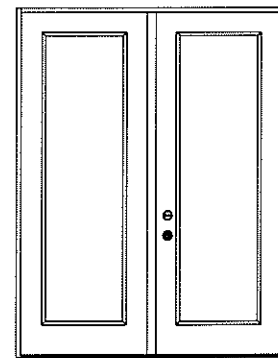

SINGLE DOOR UNIT WITH SIDELITE

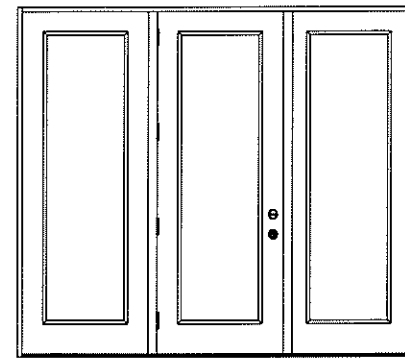

SINGLE DOOR UNIT W/SIDELITES

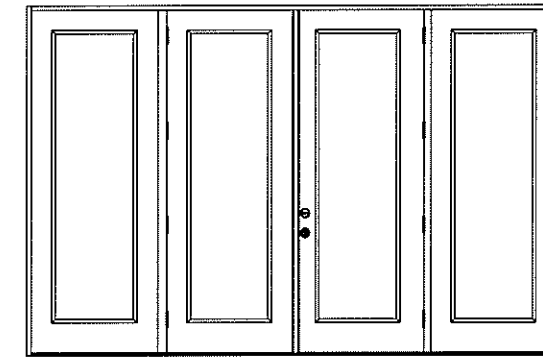

DOUBLE DOOR UNIT W/SIDELITES

TABLE OF CONTENTS	
SHEET #	DESCRIPTION
1	TYPICAL ELEVATIONS & GENERAL NOTES
2	ANCHORING LOCATIONS & DETAILS
3	ANCHORING LOCATIONS & DETAILS

CONFIG	MAX WIDTH	DESIGN PRESSURE RATING				WHERE WATER INFILTRATION PERFORMANCE IS REQUIRED TO BE 15% OF DESIGN PRESSURE			
		INSWING		OUTSWING		INSWING		OUTSWING	
		INSWING	OUTSWING	INSWING	OUTSWING	INSWING	OUTSWING	INSWING	OUTSWING
X	37.5"	+40.0 / -45.0	+45.0 / -40.0	+19.0 / -19.0	+45.0 / -40.0	+40.0 / -45.0	+45.0 / -40.0	+19.0 / -19.0	+45.0 / -40.0
XX	74"	+40.0 / -45.0	+45.0 / -40.0	+19.0 / -19.0	+45.0 / -40.0	+40.0 / -45.0	+45.0 / -40.0	+19.0 / -19.0	+45.0 / -40.0
OX or XO	75"	+40.0 / -45.0	+45.0 / -40.0	+19.0 / -19.0	+45.0 / -40.0	+40.0 / -45.0	+45.0 / -40.0	+19.0 / -19.0	+45.0 / -40.0
OXO	112.5"	+40.0 / -45.0	+45.0 / -40.0	+19.0 / -19.0	+45.0 / -40.0	+40.0 / -45.0	+45.0 / -40.0	+19.0 / -19.0	+45.0 / -40.0
OXXO	149"	+40.0 / -45.0	+45.0 / -40.0	+19.0 / -19.0	+45.0 / -40.0	+40.0 / -45.0	+45.0 / -40.0	+19.0 / -19.0	+45.0 / -40.0

MASONITE INTERNATIONAL CORP.
 7300 REAMES RD.
 CHARLOTTE, NC 28216

PRODUCT: "EXTERIOR DOOR PRODUCT"
 DOUBLE 8'0" GLAZED WOOD-EDGE STEEL DOOR
 PART OR ASSEMBLY:
 TYPICAL ELEVATIONS & GENERAL NOTES

NO.	DATE	BY	REVISIONS
C	12/15/08	SWS	ADDED SPACER

DATE: 7/11/05
 SCALE: N.T.S.
 DWG. BY: SWS
 CHK. BY:
 DRAWING NO.:
 DWG-MA-FL0131-05
 SHEET 1 OF 3

MASONITE INTERNATIONAL CORP.
 7300 REAMES RD.
 CHARLOTTE, NC 28216

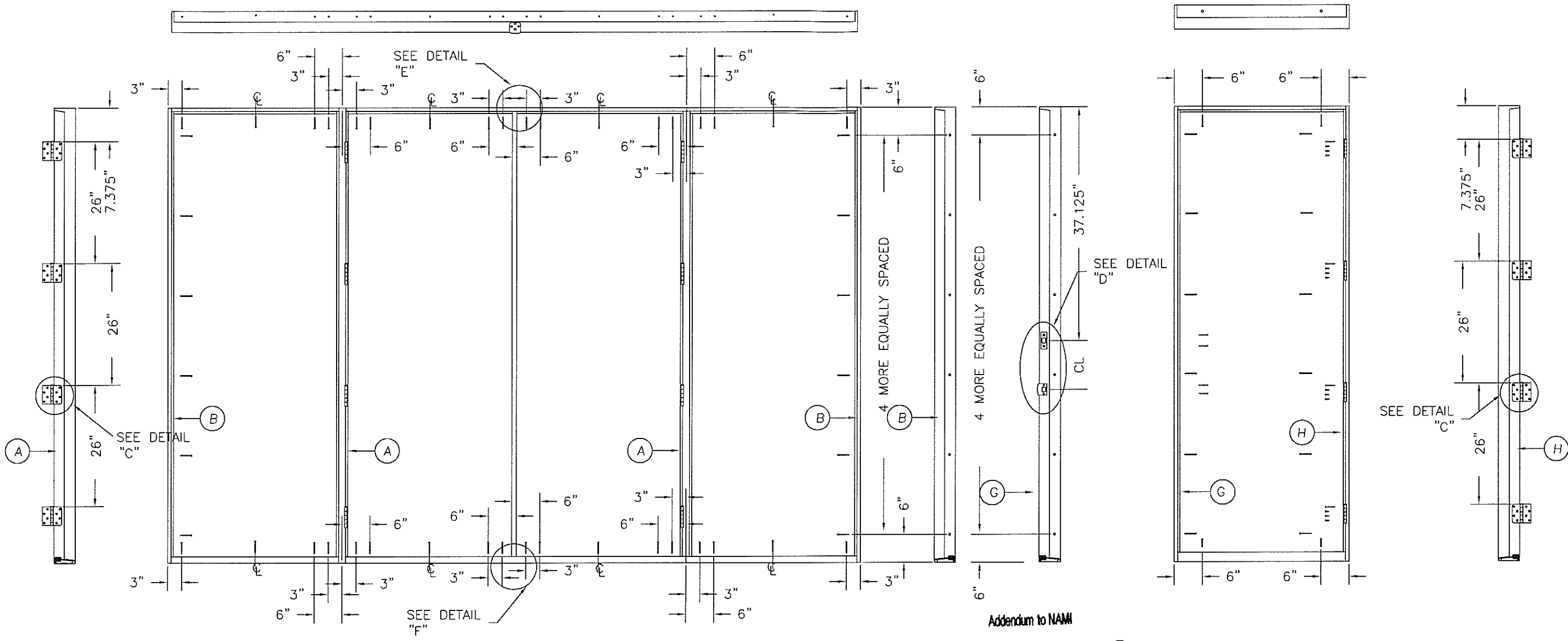

Addendum to NAMI

Certification No.: N1006110-R3
 Reviewed By: [Signature]
 Date Reviewed: 12/18/08

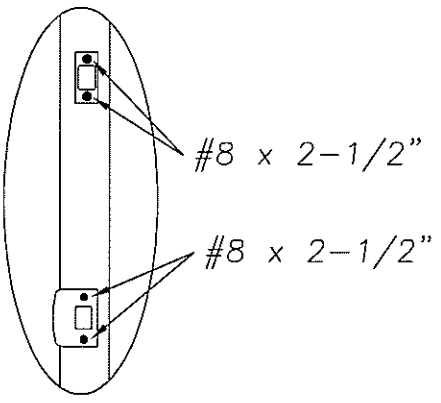

DETAIL "D"

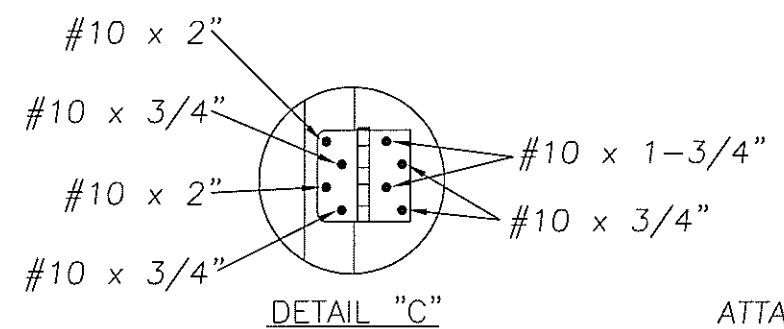

DETAIL "C"

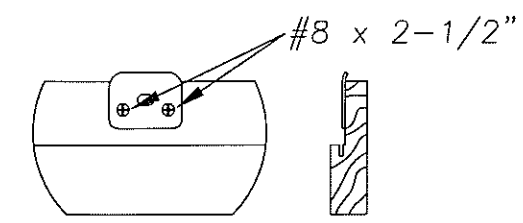

DETAIL "E" ASTRAGAL
 ATTACH ASTRAGAL RETAINER BOLT STRIKE PLATE TO FRAME AS SHOWN.

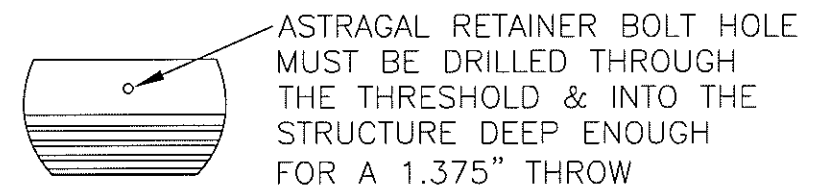

DETAIL "F" ASTRAGAL

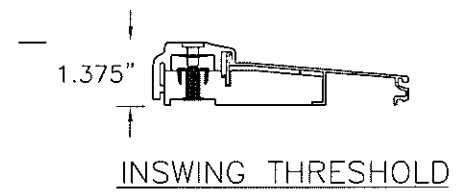

INSWING THRESHOLD

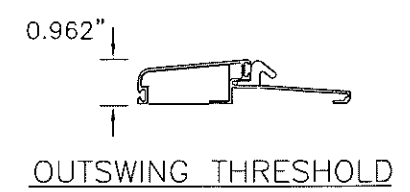

OUTSWING THRESHOLD

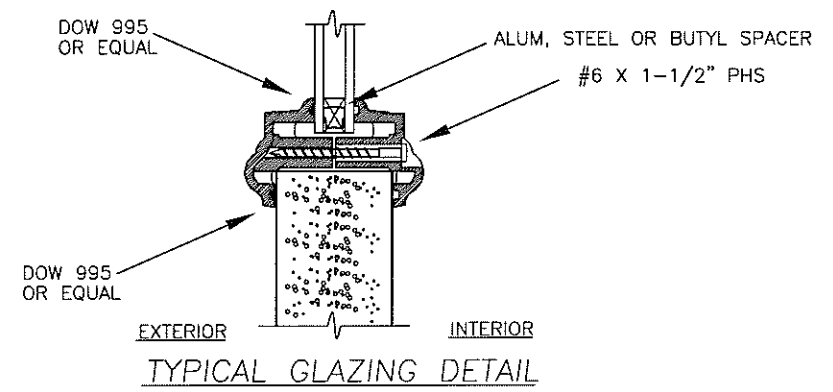

TYPICAL GLAZING DETAIL

PRODUCT:	"EXTERIOR DOOR PRODUCT" DOUBLE 80" GLAZED WOOD-EDGE STEEL DOOR
PART OR ASSEMBLY:	ANCHORING LOCATIONS & DETAILS
NO.	C
DATE	12/15/08
ADDED SPACER	SWS
BY	[Signature]
REVISIONS	

DATE: 7/11/05
 SCALE: N.T.S.
 DWG. BY: SWS
 CHK. BY:
 DRAWING NO.:
 DWG-MA-FL0131-05
 SHEET 2 OF 3

